

Second Avenue Subway

Tunnel Construction Techniques

Overview Map

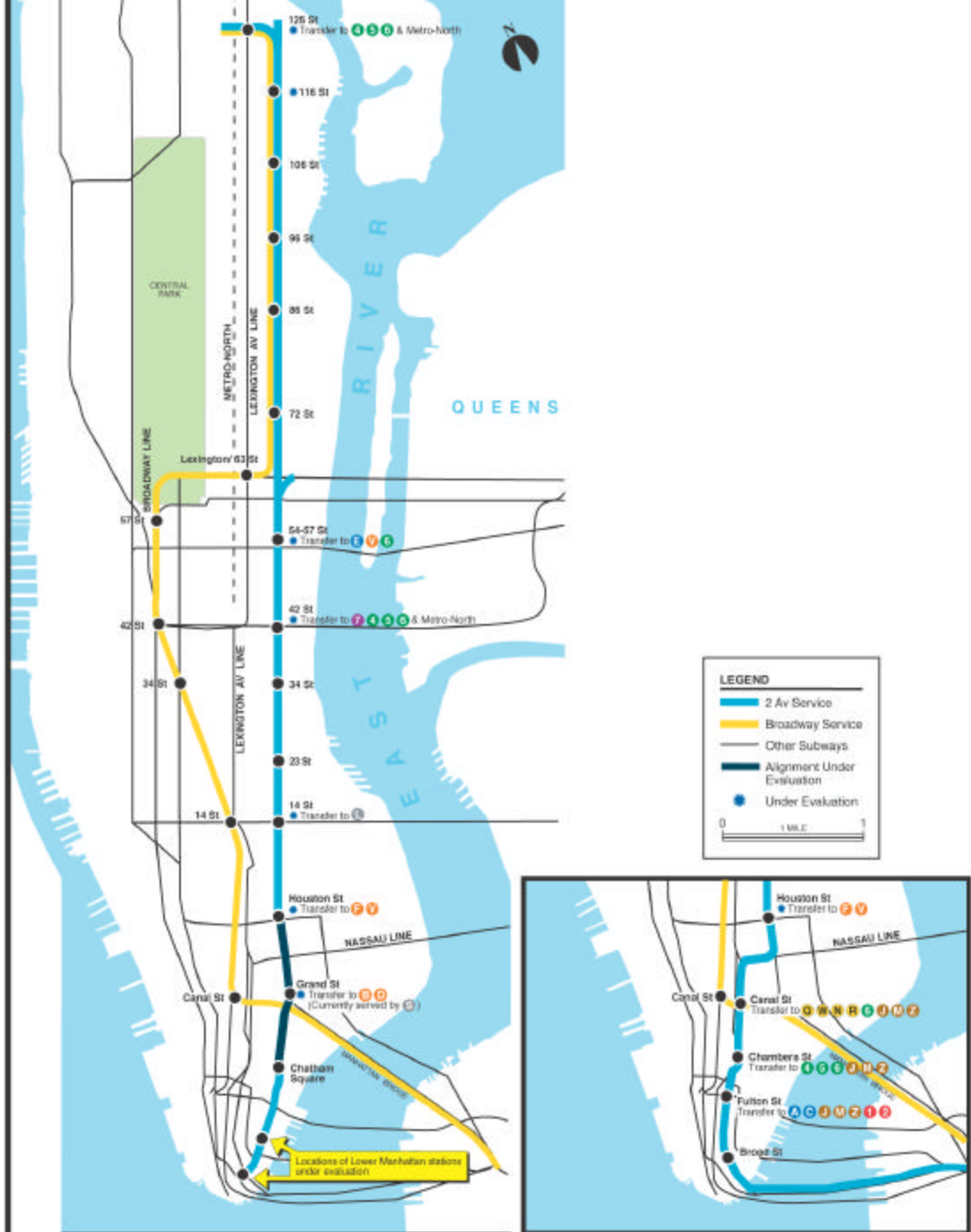

Water Street Alignment Option

Nassau Street Alignment Option



Tunnel Boring Machines

Construction

Three construction methods will be used to build the Second Avenue Subway

- Tunnel Boring
- Cut-and Cover
- Mining

Tunnel Boring

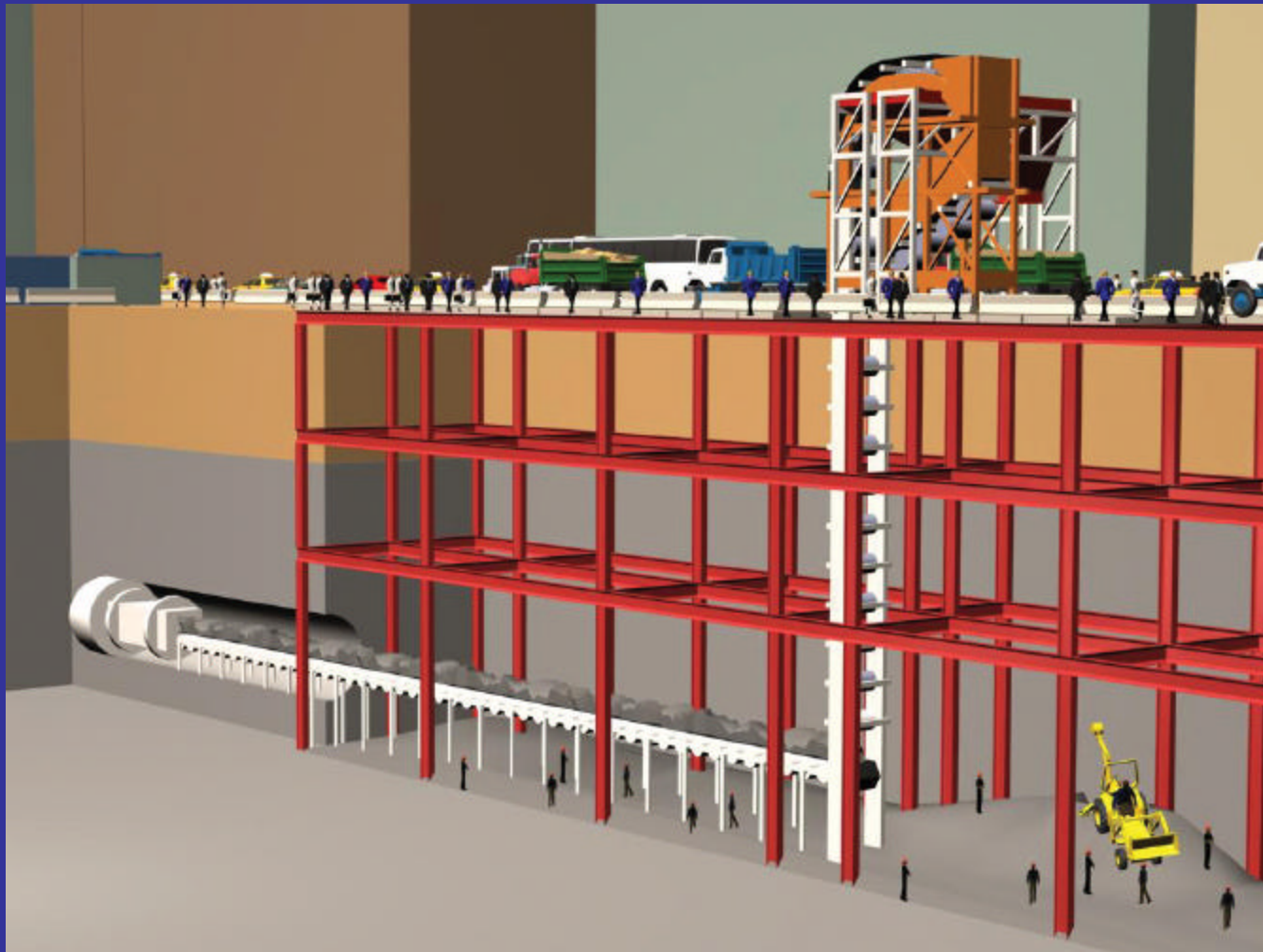

Cut-and-Cover



Mining

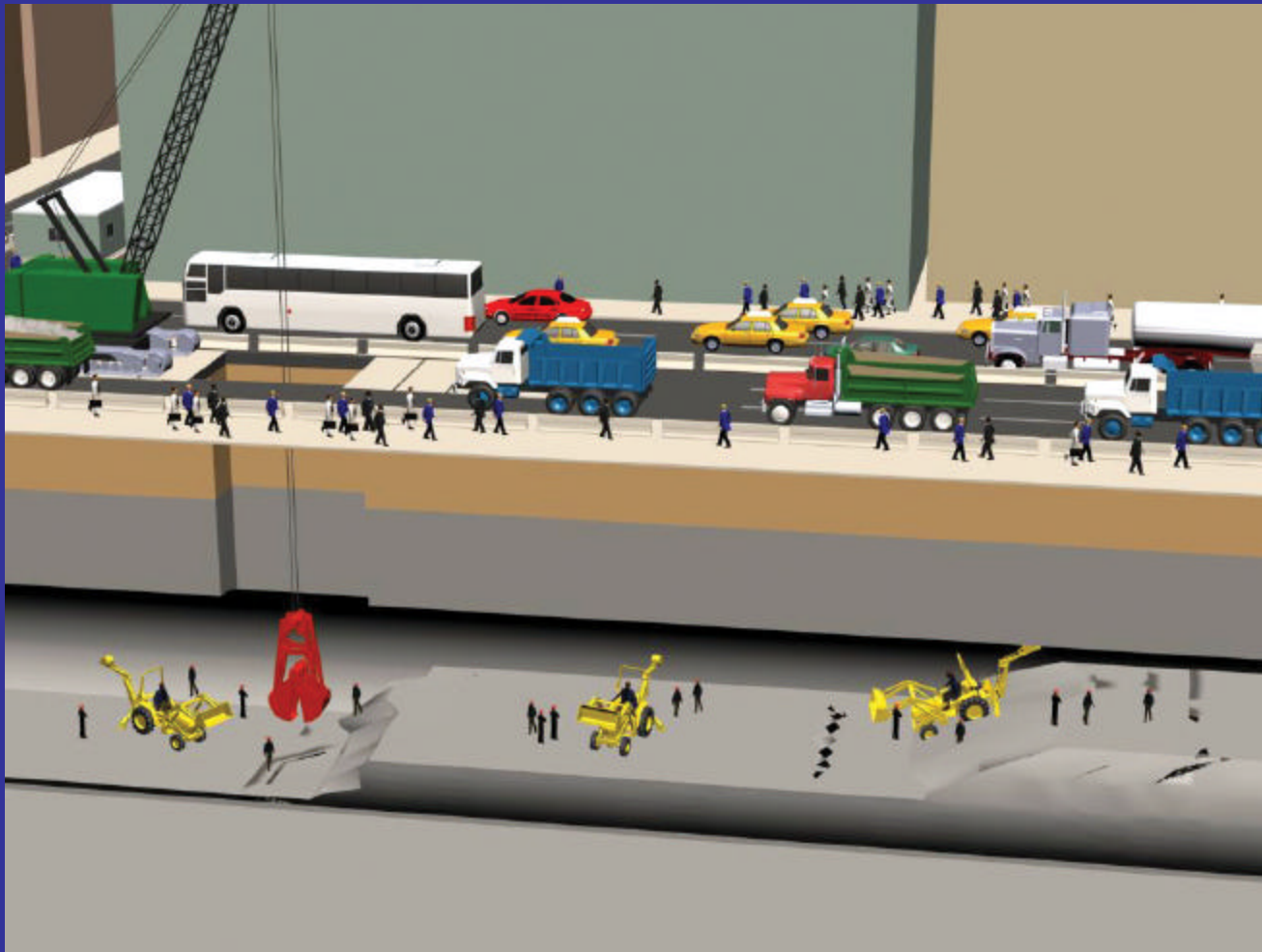

Project Profile and Alignment

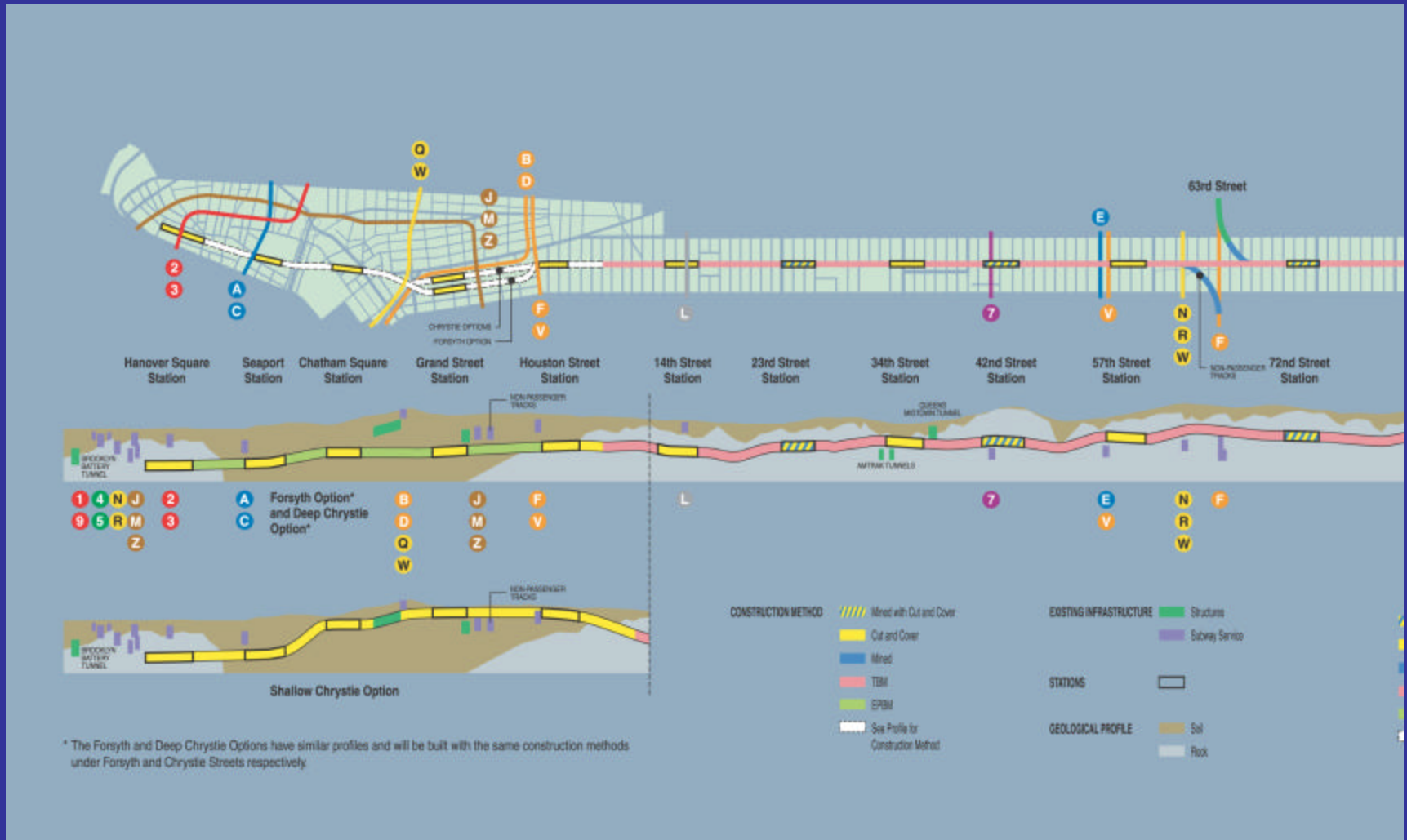

* The Forsyth and Deep Chrystie Options have similar profiles and will be built with the same construction methods under Forsyth and Chrystie Streets respectively.

Project Profile and Alignment

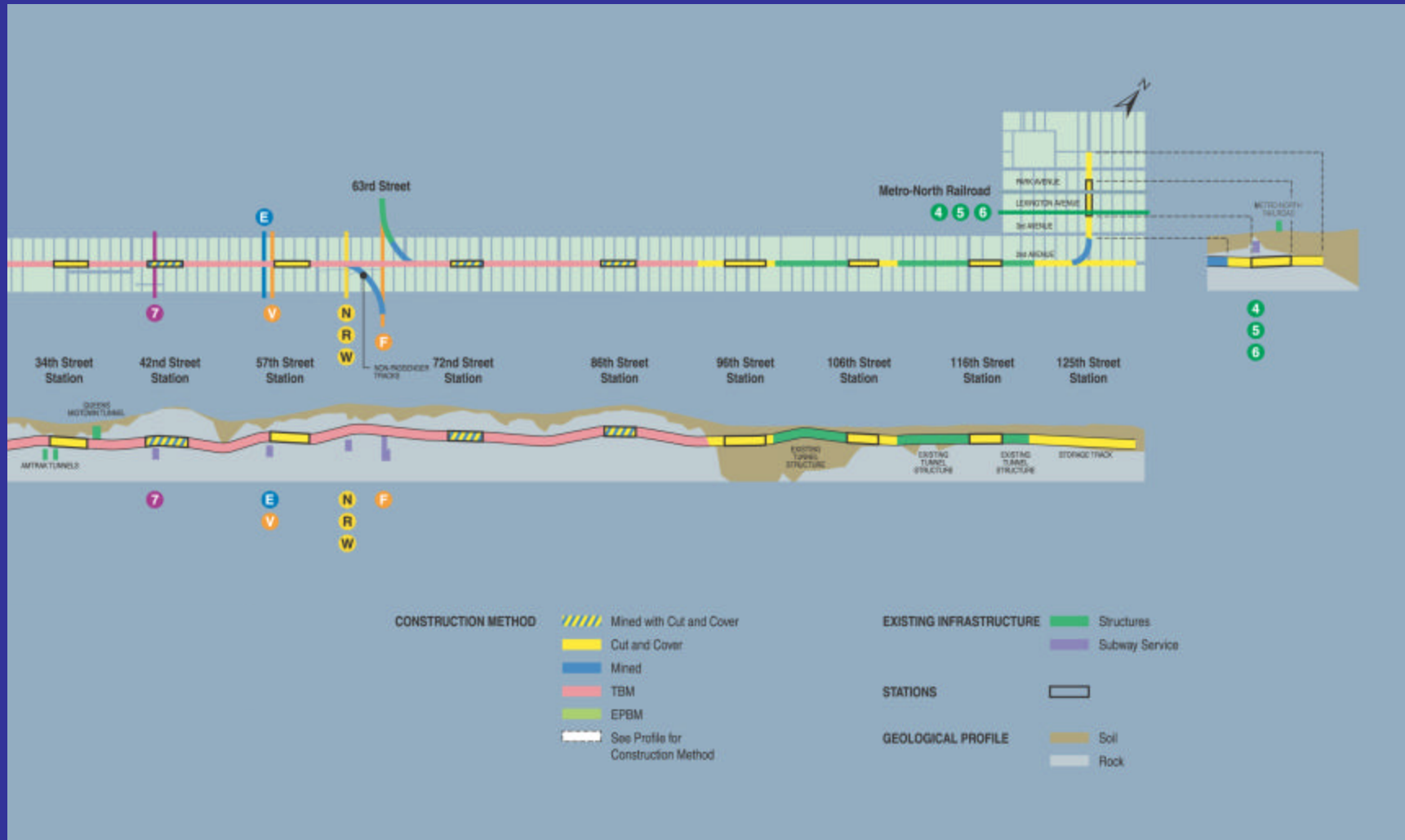

Prospective Tunnel Access Points

